

Installation instructions for axles and emergency brake assembly for Strange 12-bolt and S60 rear end for F-Body (98-02) applications.

Before you begin installation:

Read these instructions thoroughly and save for future reference.

If after reading these installation instructions, you have any questions or comments, please do not hesitate to call us.

**NOTE: A hydraulic press capable of 20,000 pounds of ram force is required for this installation.
Emergency brake assemblies must be re-used or supplied by the customer.**

Pre-Installed Parts on Axle	
Part #	Description
A1000D	Wheel Cap
B1105C	ABS Reluctor Adapter (optional)
B1105CR	ABS Reluctor Ring (optional)
A3000K	Bearing Spacer

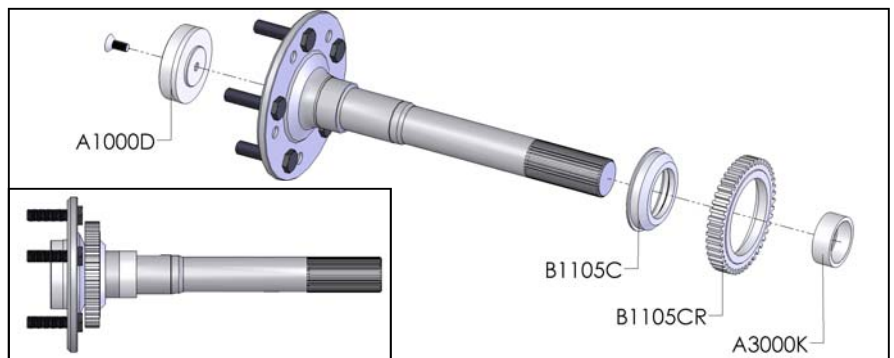

Pre-Installed Parts in Housing	
Part #	Description
A1030C	Housing Seal

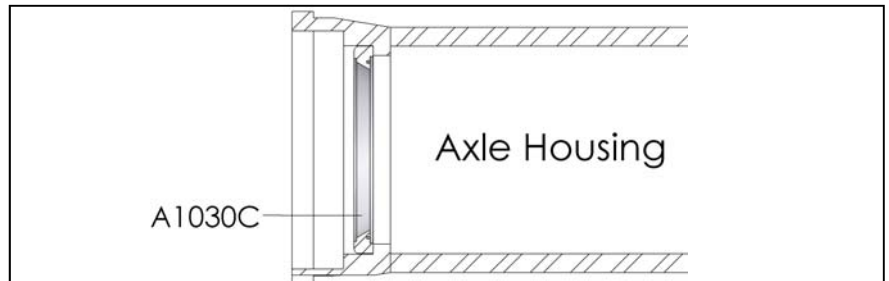

Required Installation	
Part #	Description
F1282	3/8"-24 Jet Nut
B1105D	Backing Plate Spacer
A1013	Seal and Bearing
A1021B	Wedding Ring
B1300H	3/8"-24 x 1-7/16" Tee Bolt
—	GM Emergency Brakes Assembly

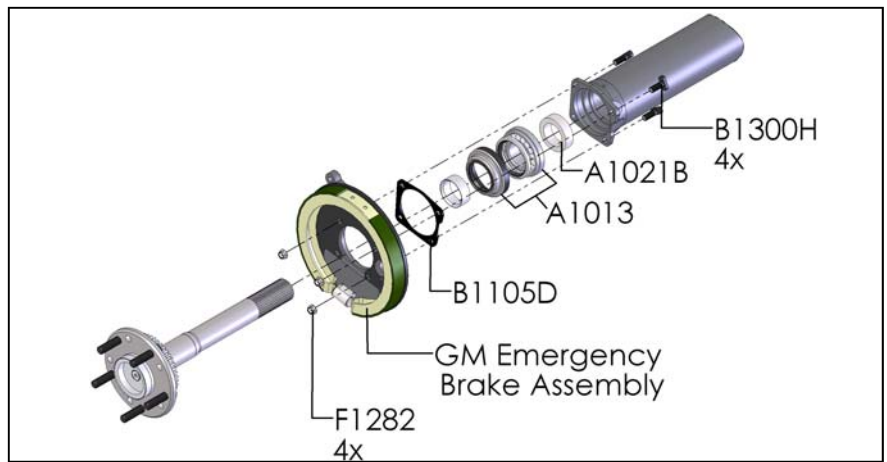

Installation instructions for axles and emergency brake assembly for Strange 12-bolt and S60 rear end for F-Body (98-02) applications.

1. Follow manufacturer's instructions to remove stock rear end from the vehicle.
2. Prior to installation emergency brake assembly must be removed from stock rear end by removing c-clips, axles and unbolting emergency brake assembly from housing.



3. Emergency brake shoes need to be removed from the backing plate to provide clearance for the jet nut installation. Slide the brake shoes up to the very tip of the hold down spring.



4. Pull the emergency brake shoes away from the backing plate to release from the hold down spring. Slide the shoes off the tappet and adjusting nut. Be careful not to move the lever in the back of the assembly otherwise the tappet and adjusting nut will slide out.

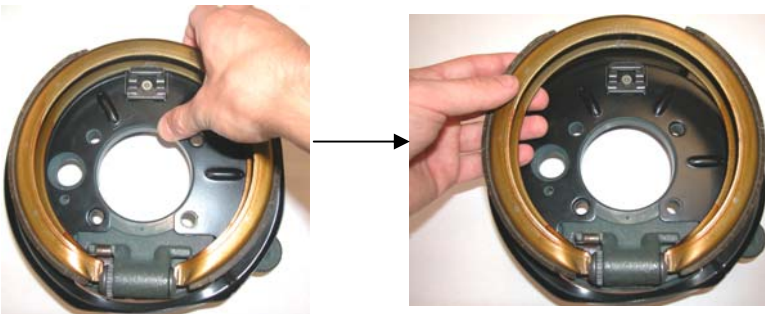

5. Take extra precaution while handling the emergency brake plate. The tappet and adjusting nut are unrestricted once the brake shoes are removed. If the emergency lever is moved in either direction the tappet and adjusting nut will slide out. The adjusting nut and tappet can be either held in position with a zip tie or slide the components out and set aside for reinstallation later. Ensure the pin is inside the tappet if components are removed.



6. Slide the emergency brake plate over the axle.
7. Slide the bearing seal (A1013) over the axle and press the bearing (A1013) onto the axle. **Only press on the inner race.** Finally, press the wedding ring (A1021B) onto the axle. Ensure bearing (A1013) is fully seated against bearing spacer. Ensure wedding ring (A1021B) is fully seated against bearing.

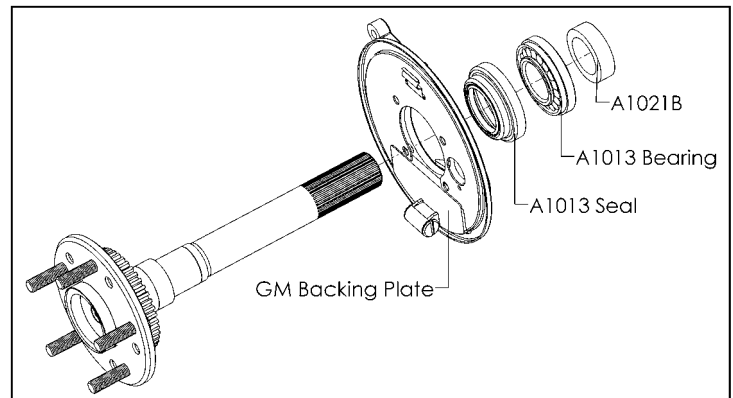

8. Install the four t-bolts (B1300H) in the housing end holes and align a housing end spacer with the four t-bolts. Begin to slide the axle into the housing.



Installation instructions for axles and emergency brake assembly for Strange 12-bolt and S60 rear end for F-Body (98-02) applications.

9. Position the backing plate assembly with the four t-bolts as the axle is slid entirely into the housing. Apply Loctite® on the four jet nuts (F1282) and install. **Tighten jet nuts as much as possible. Take precaution because the jet nuts will round off if over tightened.**

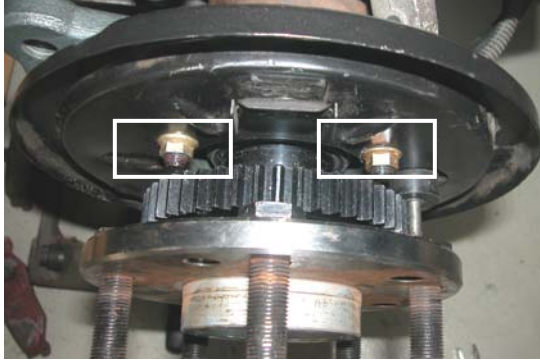

10. Reinstall the tappet and adjusting nut if the components were removed earlier otherwise detach the zip tie. Ensure pawl for adjustment and the pin in the tappet are installed.

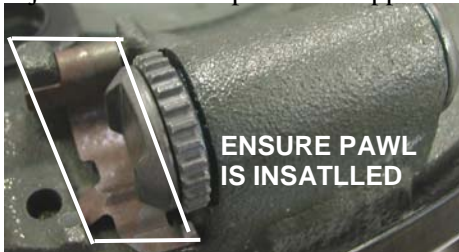

11. Slide the emergency shoes over the assembly and position with the adjusting nut and tappet. The adjusting nut can be screwed in to provide for more clearance with the rotor but it also needs to have enough thread be able to turn so the shoes can pivot behind the hold down spring.

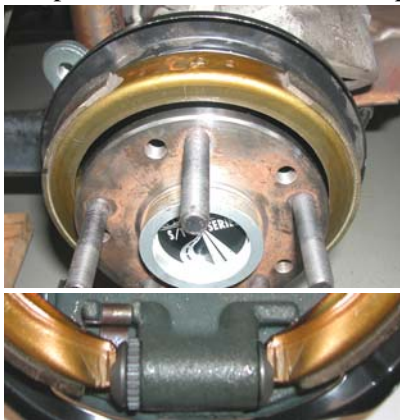

12. Pivot and push the shoes behind the hold down spring. Pull the shoes down to retain.



13. Reinstall the emergency brake cable to the lever. This is best accomplished if the emergency brake cable is disconnected from the bracket on the rear end and reinstalled after the emergency brake cable is attached to the lever. Also, install the traction control sensor plug.

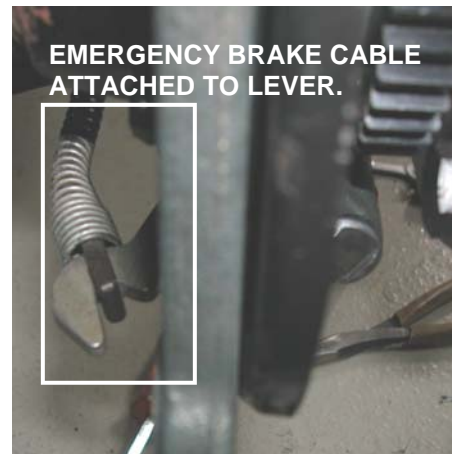
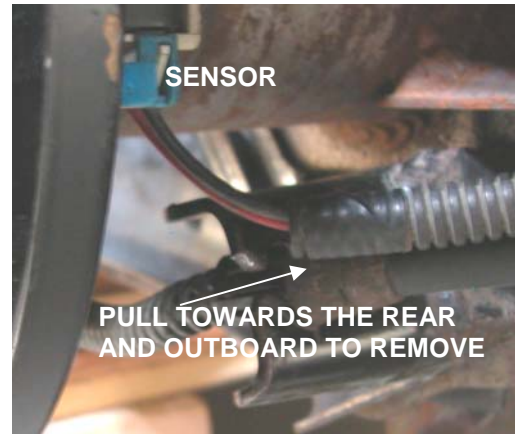

14. Ensure all bolts have proper torque. Reinstall the rotor, caliper, and wheel.



15. The emergency brake needs to be engaged and disengaged a few times for it to properly readjust.